

# ART DATA CENTRES

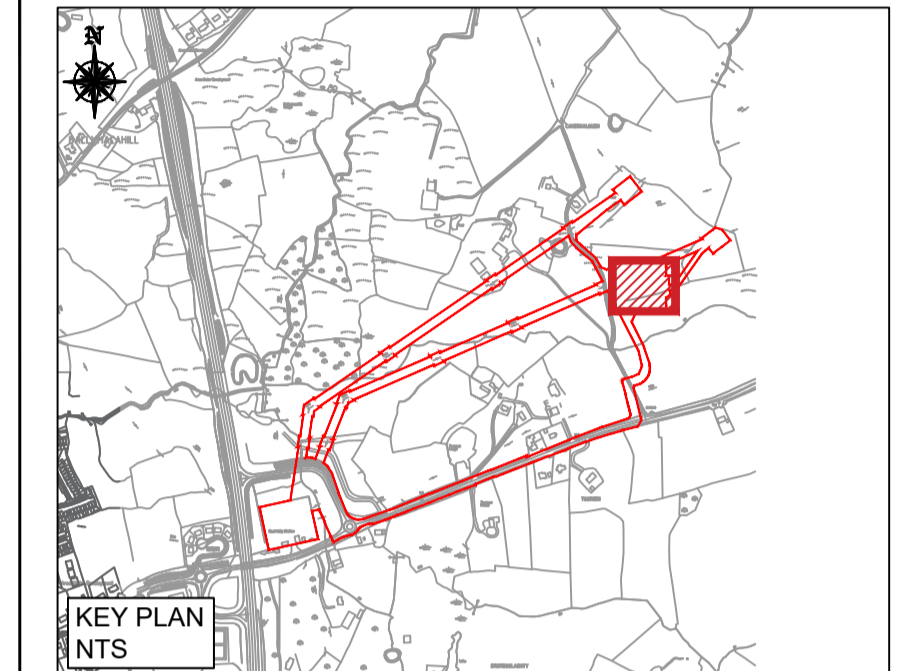

AGI DEVELOPMENT UNDER PLANING REF NO. P21/757

ACCESS ROAD UNDER PLANING REF NO. P21/757

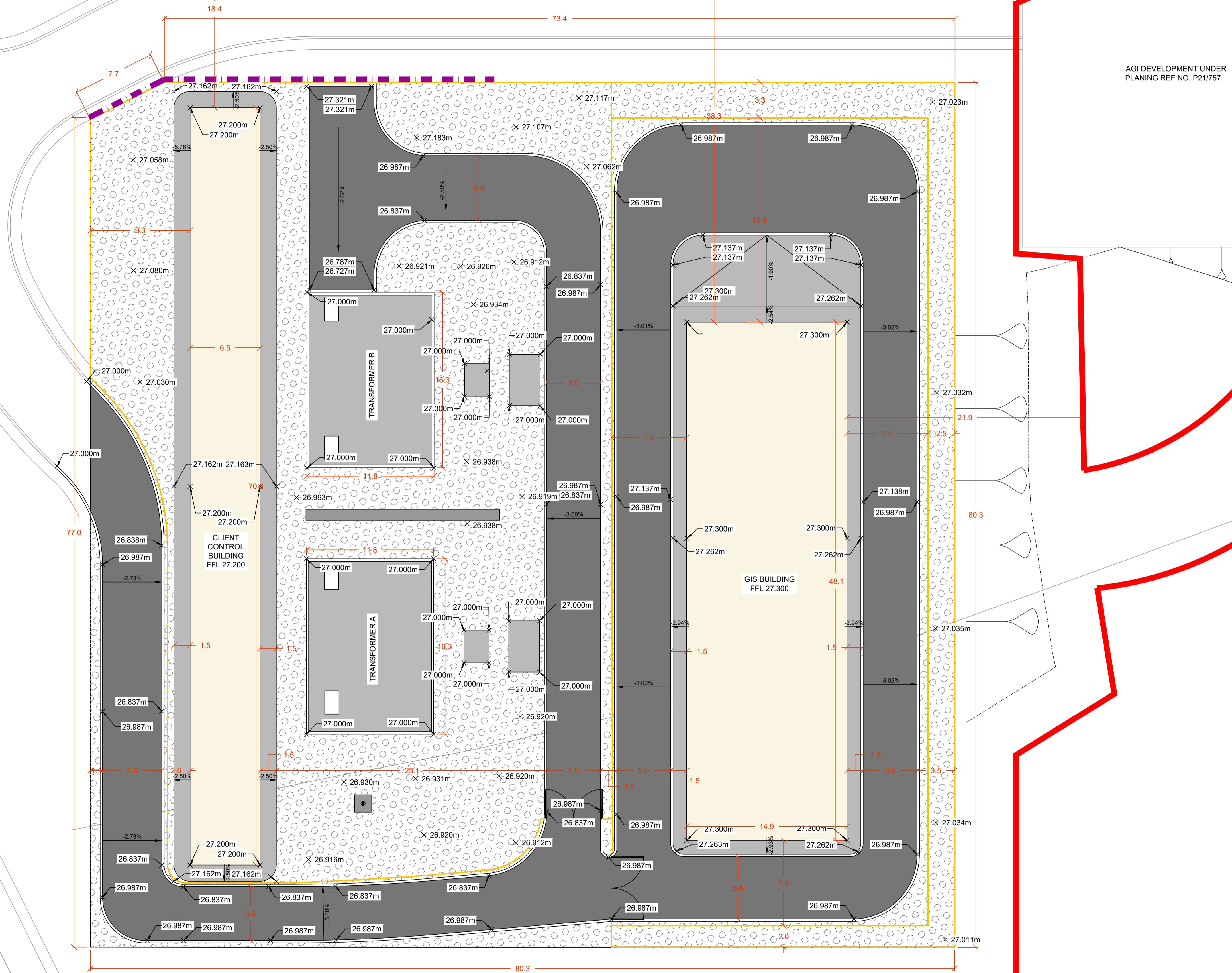

LEGEND:

- SITE BOUNDARY
- - - - PROPOSED RETAINING WALL (APPROX. 1m HIGH)
- ▭ PROPOSED BUILDING
- ▬ PROPOSED ASPHALT ROAD
- ▨ PROPOSED STONED AREA
- ▩ PROPOSED SAND PIT
- ▧ PROPOSED RETAINING WALL (APPROX. 1m HIGH)
- PROPOSED 19m HIGH LIGHTING MAST

Rev	Description	Drawn	Checked	Date
P01	FOR PLANNING	PS	RG	03/06/22

Clifton Scannell Emerson Associates Limited  
Consulting Engineers,  
3rd Floor The Highrise,  
Bakers Point, Pottery Road,  
Dun Laoghaire, Co. Dublin,  
Ireland, A96 KW29

T. +353 1 288 5006  
F. +353 1 283 3466  
E. info@csea.ie  
W. www.csea.ie

Client: ART DATA CENTRES  
Project: ART DATA CENTRES ENNIS  
Project: CAMPUS - 110KV GIS SUBSTATION  
Proposed SUBSTATION COMPOUND LAYOUT

Drawn By: PS Checked By: RG Date: JUN 2022

Project Code: 20\_110A - CSE - GEN - XX - DR - C - 2120

Status Code	Suitability Description	Scale
S2	PLANNING	@ A1 1:200
P01	PLANNING	20_110A